

30T-ES GEH

Vandalism protected keyboard

- *for public surroundings*
- *extrem weather conditions*
- *and many more*



30T-ES GEH

stainless
steel

Description:

- A vandalism protected keyboard with 30 buttons in different layouts in very robust processing.
- Almost insensitive to violence.
- Table version in a complete stainless steel enclosure.
- Explicitly for surroundings where there is danger by vandalism and/or much customer traffic and/or extrem weather conditions.
- Especially suitable for industrial extreme surroundings.

Features:

- All electronic components and mechanical guides are protected against ingress of dust and water spray (protection IP 65).
- Convenient and positive operation due to the 3,25 mm travel keys with tactile feel.
- Completely in stainless steel construction 1.4301 (buttons, enclosure with 1,6 mm strength).
- Key labelling in laser procedure, all keys totally and freely programmable.
- PCB with electronic components.
- Carbon contact-technology.
- Predestined for the work in public surroundings, with machines and devices which have to work in extreme damp (even splash water) or very dusty surroundings, and many more.

Order number for example:

notation: 30T-ES G PS2 GEH1
article number: 010020220101500EE00

More information to each variant and their order numbers, see our web-site at

www.dskeyboard.com

Mechanical Data:

- Travel 3,25 mm, tactile feel
- Operation force 0,65 N
- 30 buttons, compact layout
- Durability > 10 million ops.
- Storage temperature -40°C - +70°C
- Operation temperature -20°C - +60°C (optional -20°C - +60°C)
- Protection IP65

Layouts:

- All variants are possible.

Variants:

- Custom-designed variants are possible (see our web-site).

Connecting-Variants:

- DIN, SubD9-PS/2, PS/2, USB
- Cable straight or spiral-shaped
- Cable length 1,5 m
- Other length are possible

Detail views:

- Ergonomic, compact 15mm button arrangement on the smallest area.



Electrical Data:

- Power supply + 5 V/DC, 50 mA
- Bidirectional serial output in IBM format / PS/2 / DIN
- 2-key roll over
- Autorepeat
- 16k EEPROM memory
- CE-conformable
- EMC-conformable
- RoHS-conformable

Principle:

- Contact by a silicon switch pad with carbon contacts.

Use Possibilities:

- Extreme damp (even splash water) surroundings
- Very dusty surroundings
- Test- and measurement systems
- Machine- and device construction
- Trade and craft
- Industry
- Many frequented areas
- and any more

- Very robust steel construction
- Qualitatively excellent processing



Dimensions:

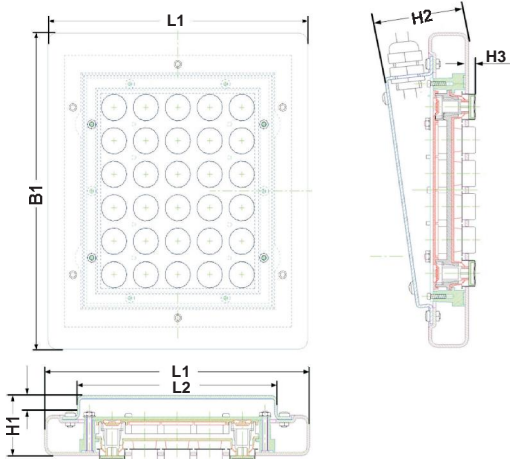

L1 = 155,10mm
L2 = 117,00mm

B1 = 180,00mm

H = 23,00mm
H1 = 43,70mm
H2 = 43,70mm
H3 = 4,00mm

More information about the measurements can be downloaded from our web-site.

30T-ES GEH

stainless
steel

DS Keyboard Technic GmbH

Herrenlandstr. 31-35
78315 Radolfzell

Tel.:
+49 (0) 7732-82385-0

Fax:
+49 (0) 7732-82385-29

Mail:
info@dskeyboard.com

Internet:
www.dskeyboard.com