

Kodierleisten für die Fördertechnik

Codier-Klappleiste zum Aufstecken

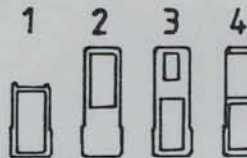
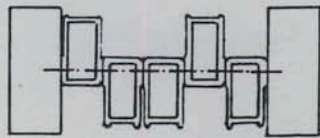

verschiedene Festmarken

- ① klein, beweglich
- ② groß, fest
- ③ groß, beweglich
- ④ groß mit Ausfräsung, beweglich

Aufsteckbefestigungs-Klammern

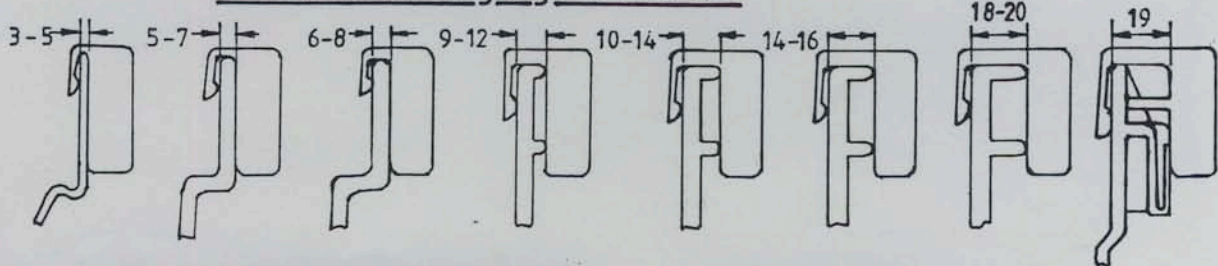

Codier-Klappleiste zum Aufschrauben

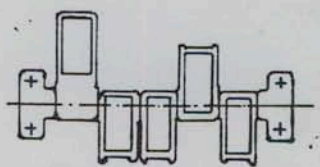

mit Schraubendurchgang

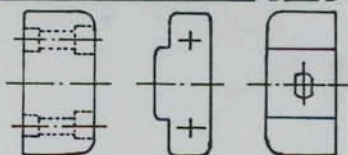

Endstücke

zum Anschrauben

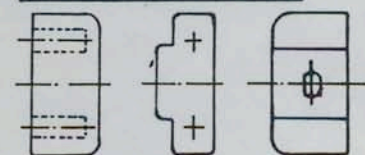

Zwischendistanzen nach Bedarf

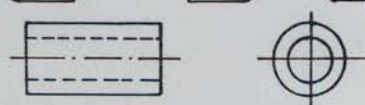

Codier-Kippleiste zum Anschrauben

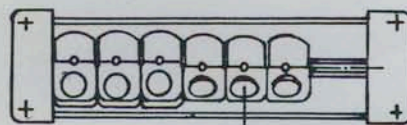
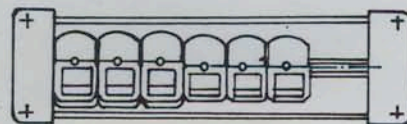
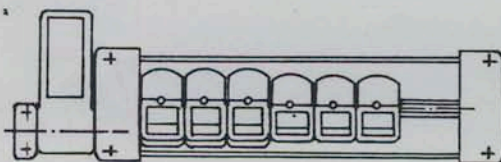

induktivabstastung

Codier-Schiebe-Leisten

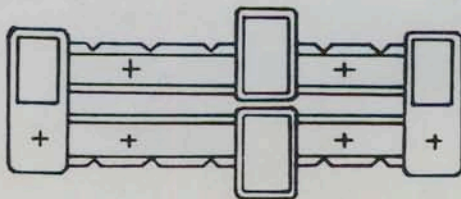
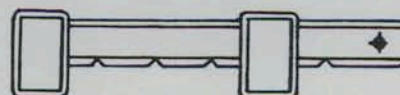
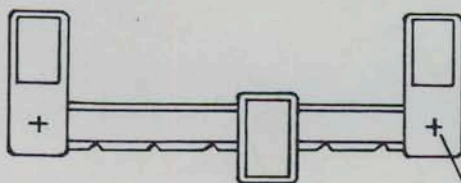

für Blechschraube 3,9 mm ϕ
Gesamtlänge nach Bedarf
Anzahl der Ziele nach Bedarf

Codier-Klappleiste zum Aufschrauben mit fester, großer Festmarke

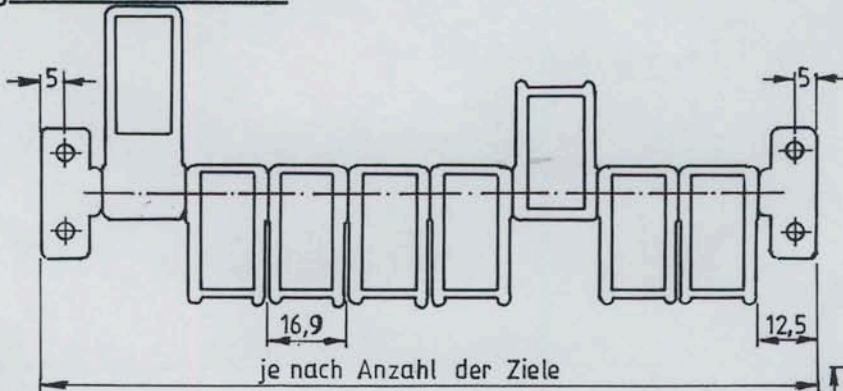

Endstück für Codier-Klappleiste mit Schraubendurchgang

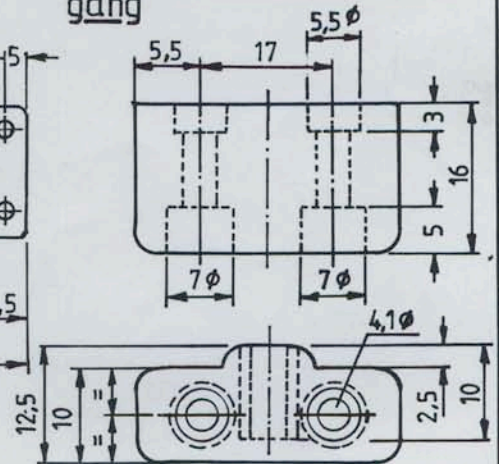

Zwischendistanzen

Länge nach Bedarf

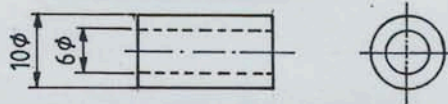

Codier-Klappleiste zum Aufschrauben mit beweglicher kleiner Festmarke

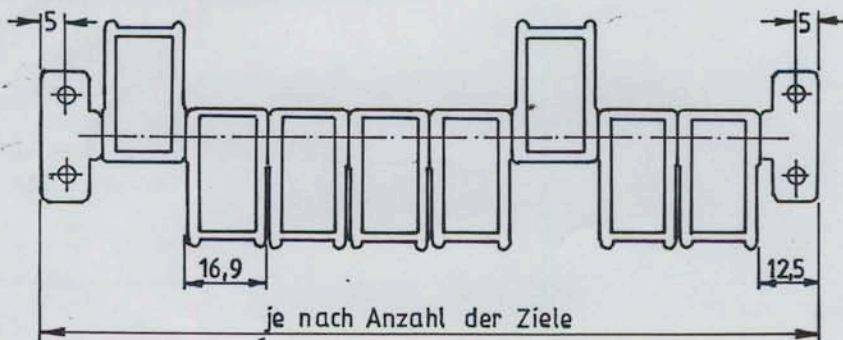

Endstück für Codier-Klappleiste

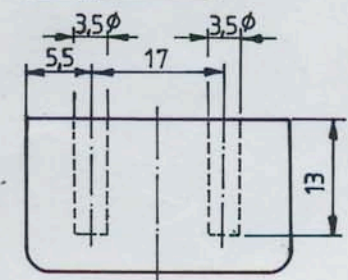

Codier-Klappleiste zum Aufschrauben mit beweglicher großer Festmarke

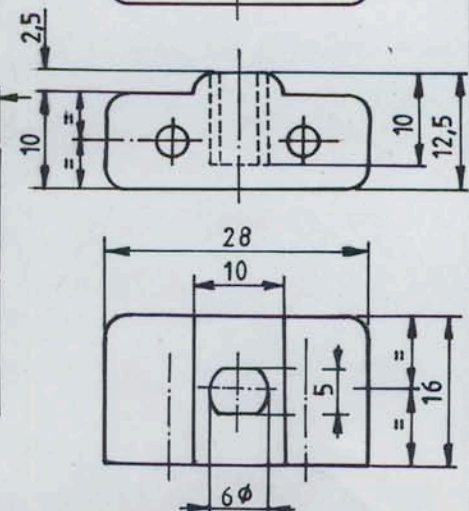
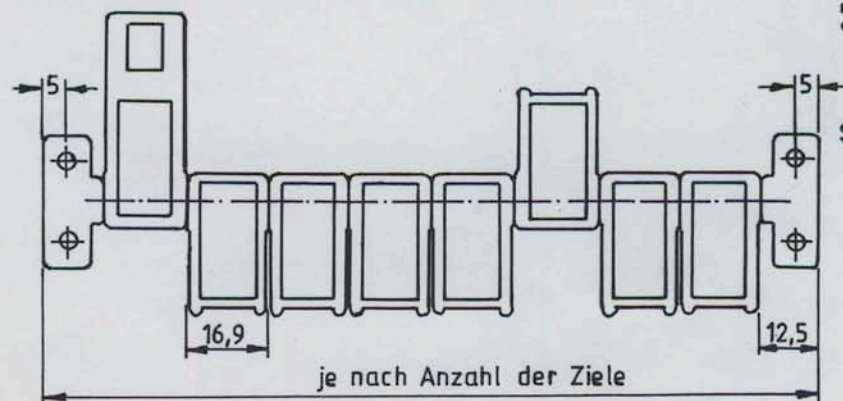

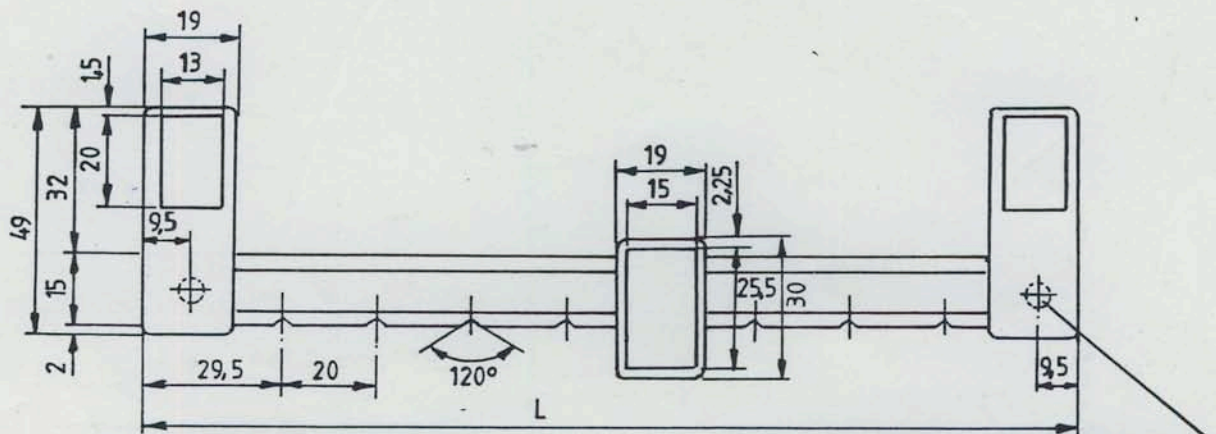

L=Gesamtlänge nach Bedarf
Anzahl der Ziele nach Bedarf

als Befestigungsloch an Kastenwand
zu verwenden für Blechschraube 3,9 mm ϕ

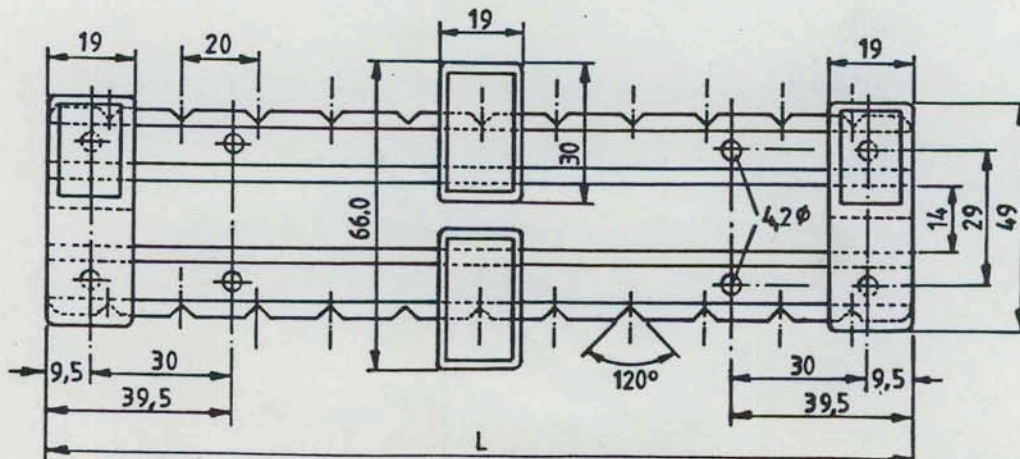
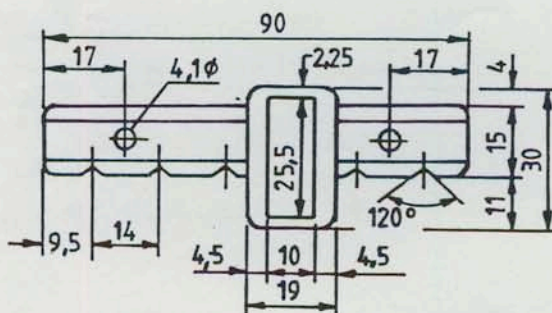
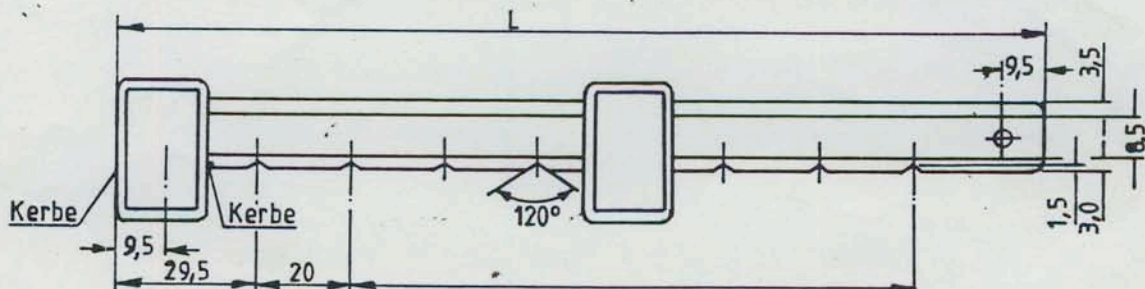

Lieferprogramm

Fiessler Elektronik
Kastellstr. 9 D-73734 Esslingen
Telefon: 0711 / 91 96 97-0
Telefax: 0711 / 91 96 97-50
www.fiessler.de
E-Mail: info@fiessler.de

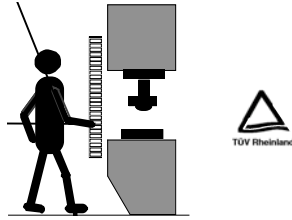

Sicherheits-Lichtvorhänge

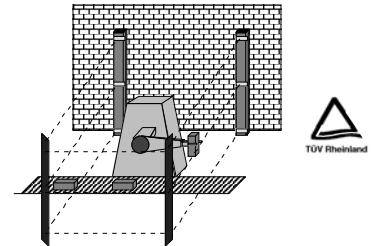

Sicherheits-Lichtgitter

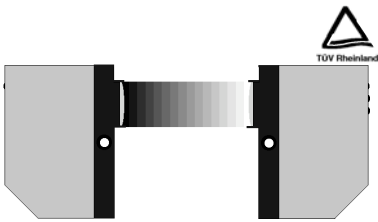

Einstrahl-Sicherheits-Lichtschranke

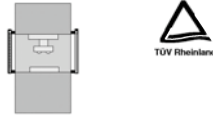

Sicherheits-Lichtgitter mit Mutingfunktion

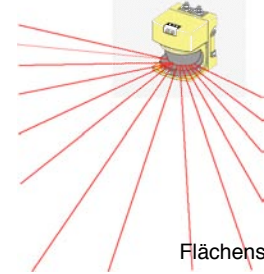

Flächenscanner

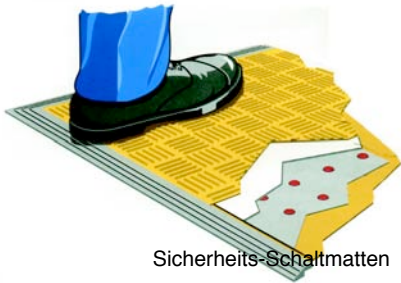

Sicherheits-Schaltmatten

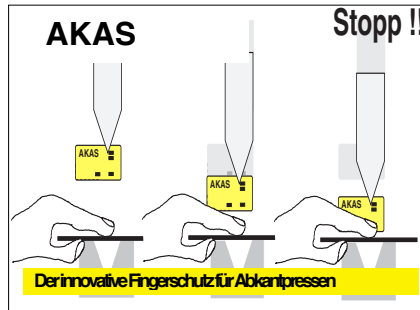

Sicherheits-Fußschalter

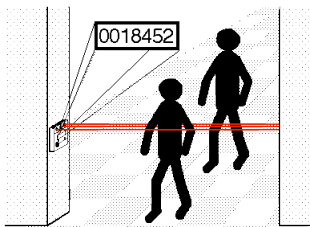

Zähllichtschranken

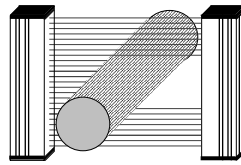

Schaltende und messende Lichtvorhänge

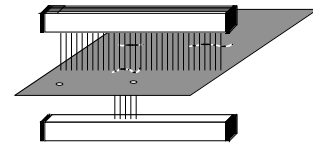

Lochsuchgeräte

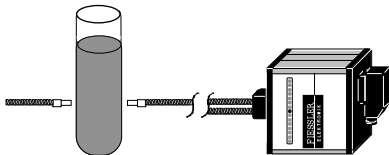

Trübungssensoren

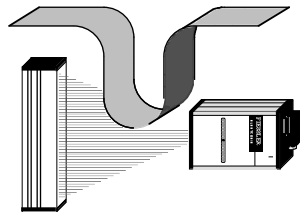

Analoger Durchhangsensor

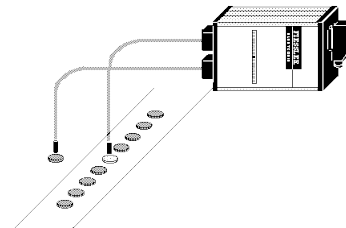

Referenzkaster



EX-Lichtschranken

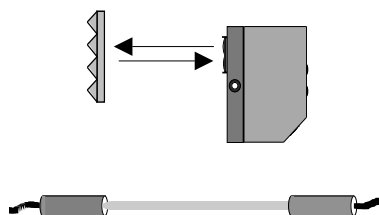

Lichtschranken für allg. Anwendungen



Ihre Anwendung